



Elevated Deer Blind:

10' floor elevation.

8'x6' Floor.

Suitable for additional ground blind at base.

Multiple Hunters, Cameraman, Youth Hunters,
Shooting Rest, Abundant Gear Space, Seniors.

Competitive (cost saving) Pricing to Commercial
Brands.

WILL LAST A "LIFETIME"!



- Size and Height
- Durability
- Comfort
- Functional and Practical

A project for the “*do it yourselfers*”

- This is inherently dangerous work at heights!
- Appropriate safety harness, work cage, bucket truck, etc...
- Although I have constructed these entirely by myself, a working partner is highly recommended if possible!
- *“Proceed at your own risk” - Liability Disclaimer*
“I ain’t no construction expert, but these blinds are working great for over 9 yrs so far .”



Project Overview:

- Location, Site Plan and Site Prep.
- Post Holes, Foundation, Posts and Bracing.
- Beam Construction, Post Attachments, Joists and Flooring.
- Framing and Wall Raising.
 - Front wall with window, back wall with door, two equal side walls with small windows.
- Rafters, Purlins, Roofing and Drip Edge
- Siding Panels, Windows and Doors.
- Ladder Stair
- Materials List



Location, Site Plan and Site Prep.

- Pick an area in proximity to deer patterns that are predictably consistent in the same area year after year.
 - An example of this could be a field edge.
- The construction location should be amenable to digging foundation holes 18-24”.
- Consider how you will approach the stand, considering concealment, quiet, wind, time of day, etc ...



Post Holes, Foundation, Posts and Bracing.

- Post holes at least as deep as frost line, but minimum 18" recommended - deeper has been my practice (24" when possible).
- Diameter of post holes 9" minimum and 12" suggested.
- 4-6" of redi-mix at base, with 4x6 PT post placed centrally with attached post base. Backfill foundation hole with redi-mix (recommended) or fill dirt firmly compacted.
- Very important to make all posts at right angles (true rectangle) – remember 3-4-5 rule to make corners square.
- Recommend placing cross bracing as next step after posts placed.
- Posts cut level with each other at 10' maximum height.
- 2x6 PT laminated to outside edge of post with 3" deck screws starting at grade and ending at beam height; this is what will secure beam to post.



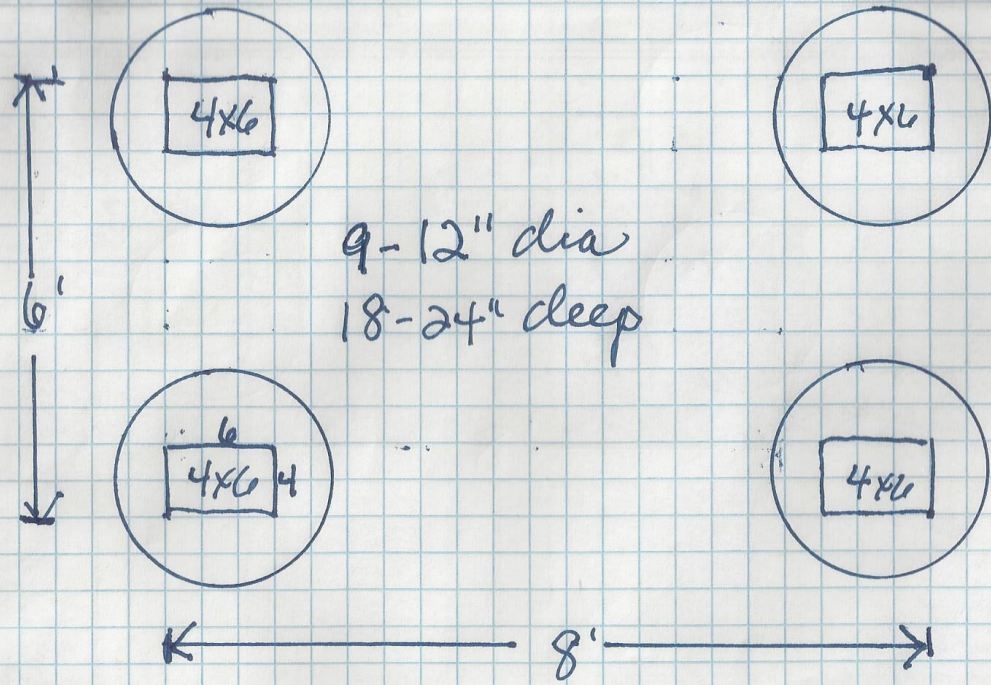

FOUNDATION

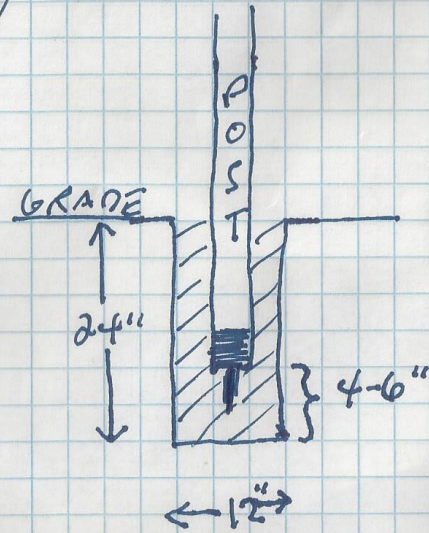

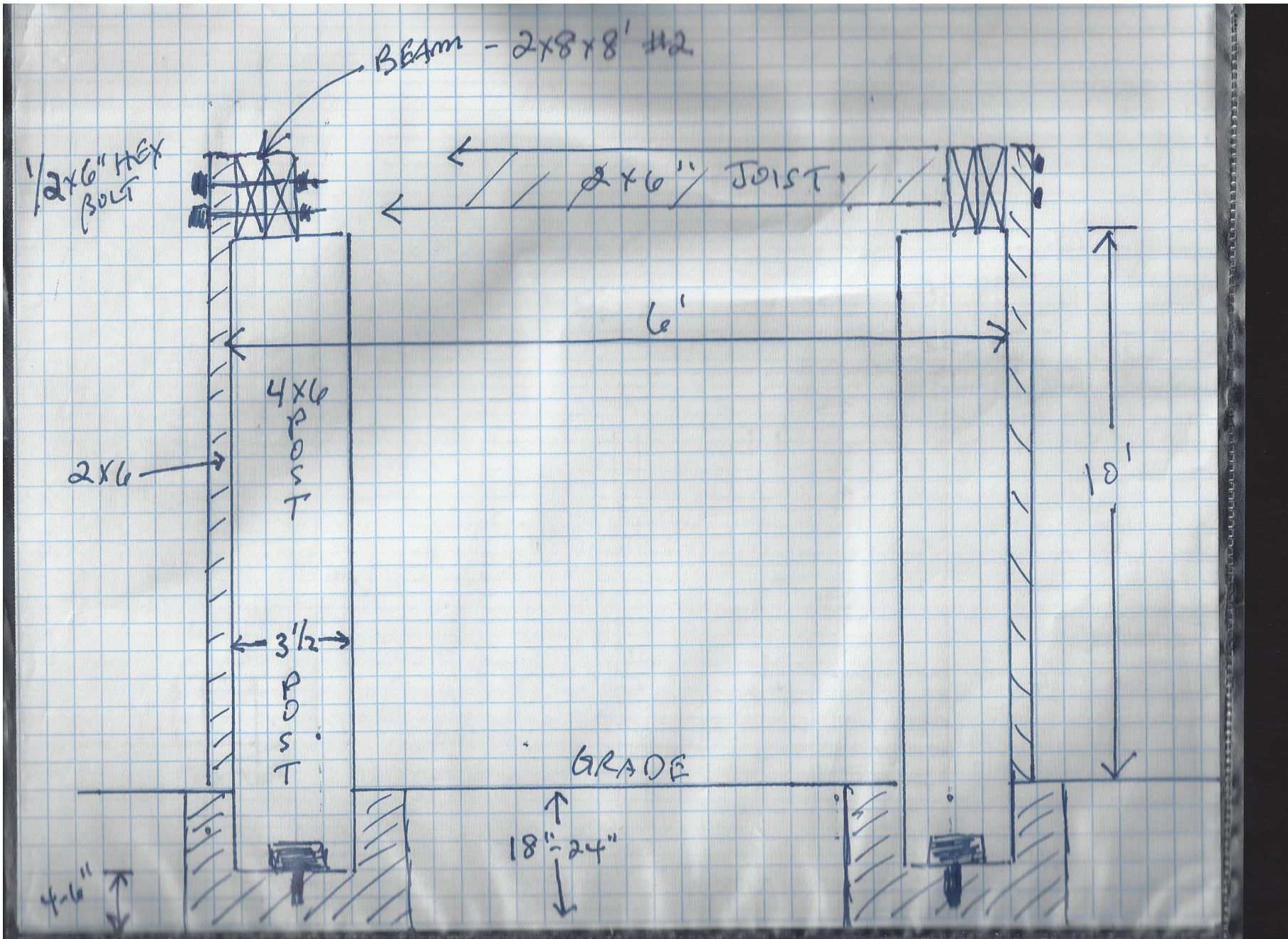

Beam Construction, Post Attachments, Joists and Flooring:

- Beam constructed of 2"x8"x8' PT – two of them laminated together with wood glue and 3" deck screws making one beam; will need 2 beams.
- Beams lay on top of posts side to side, and are secured to post by bolting beam to the 2x6 that was laminated to outside of post. Use ½" x 6" hex bolts galvanized or zinc plated.
- Use conventional joist hangers for the central 2x6 joists (PT), but need inverted flange joist hangers for the outer joists.
- Plywood flooring completes the 6x8 elevated base frame. PT plywood recommended but not absolutely required.
- Pressure Treated (PT) wood recommended for posts, beams, and joists; PT flooring optional. This "weather protects" the foundational elements of the elevated blind to promote longevity of structure. *Need deck screws or galvanized/zinc nails for any attachments to PT wood.*



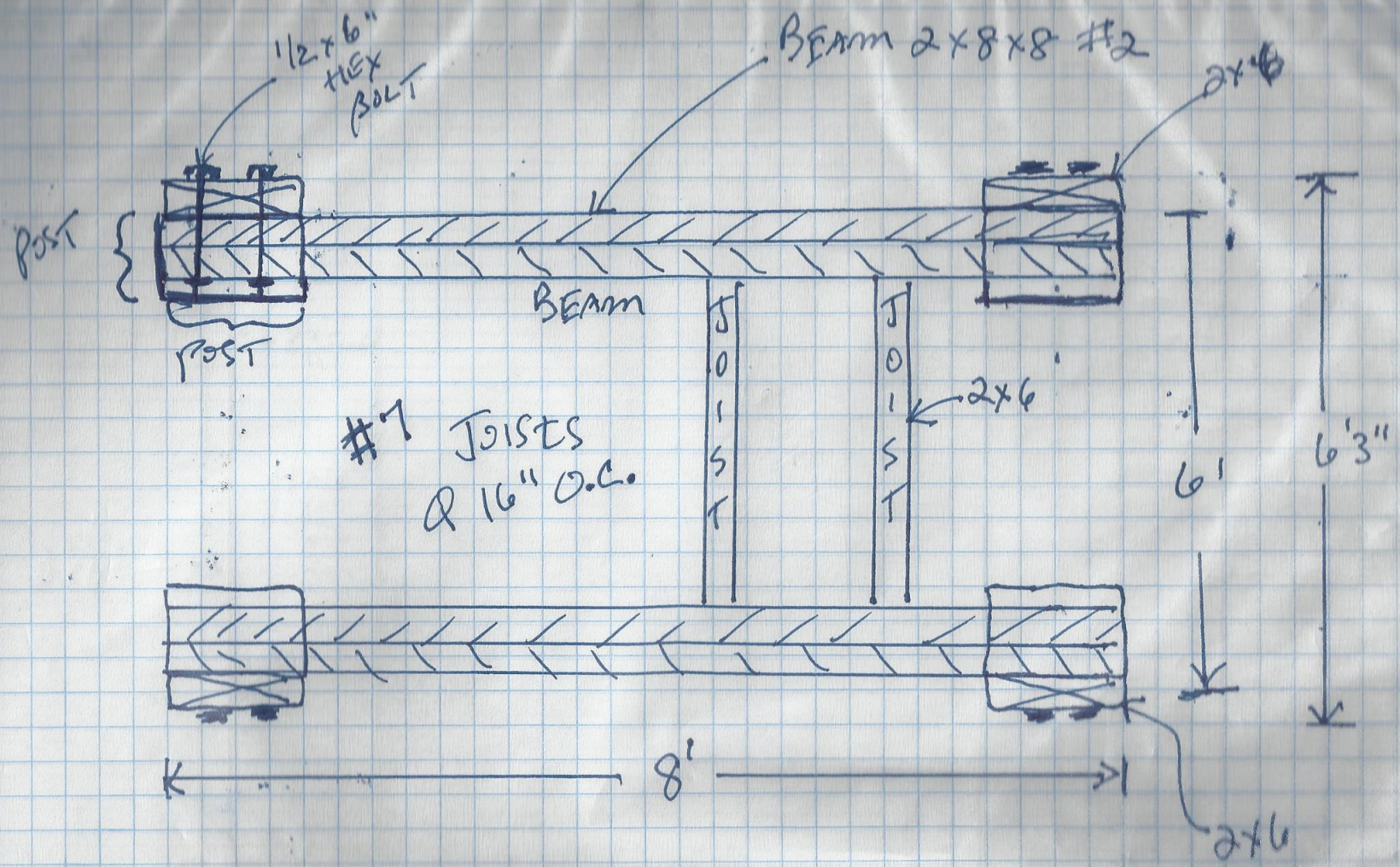

3/4" PLYWOOD FLOOR 6'x8'

JOISTS EVERY 16" O.C.

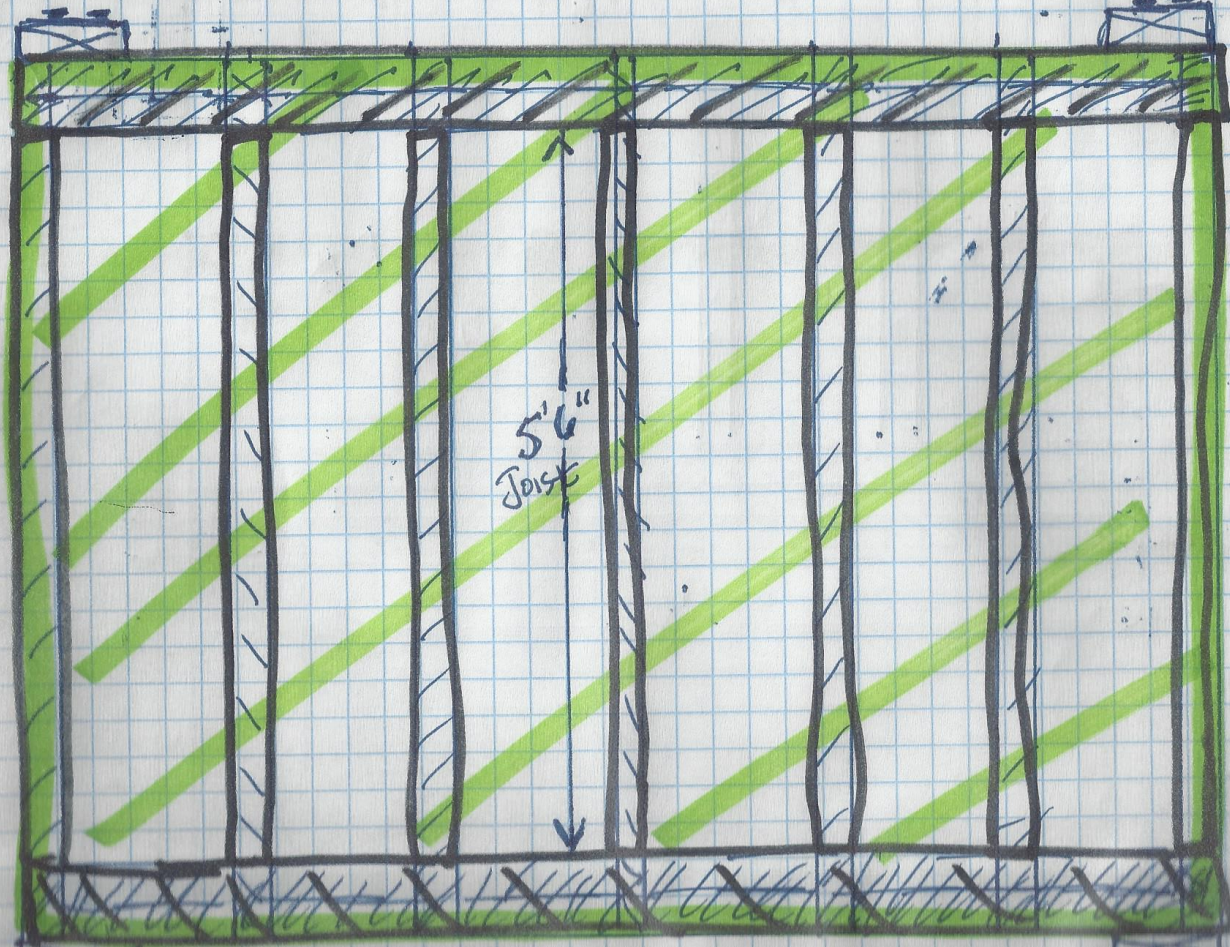
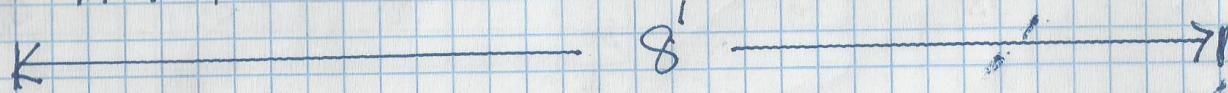

FLOOR PLAN

6'

2x6 BEAM ATTACHMENT



- At this point you may want to go to constructing and placing the stairway, so you can use it throughout the remainder of the construction process.
- If not, proceed to framing and do stairway later.



Framing and Wall Raising.

- Need to frame a front wall with long front window, back wall with door, and two equal side walls with small windows.
- Remember 3-4-5 rule to keep walls square.
- Front wall is 6" taller than back wall (and side walls), to provide grade front to back.
- Double studs at 48" allow ease of placement of siding for those of us that aren't so good at all of this...
- PT perimeter of sides and bottoms of windows and doors suggested, as these areas will be regularly exposed to the elements.
- Generally, back wall placed first, then side walls, then front wall.
- Walls need to be square and placed level/"plum" on the base platform.



FRONT WALL

P.T. Window Frames SUGGESTED

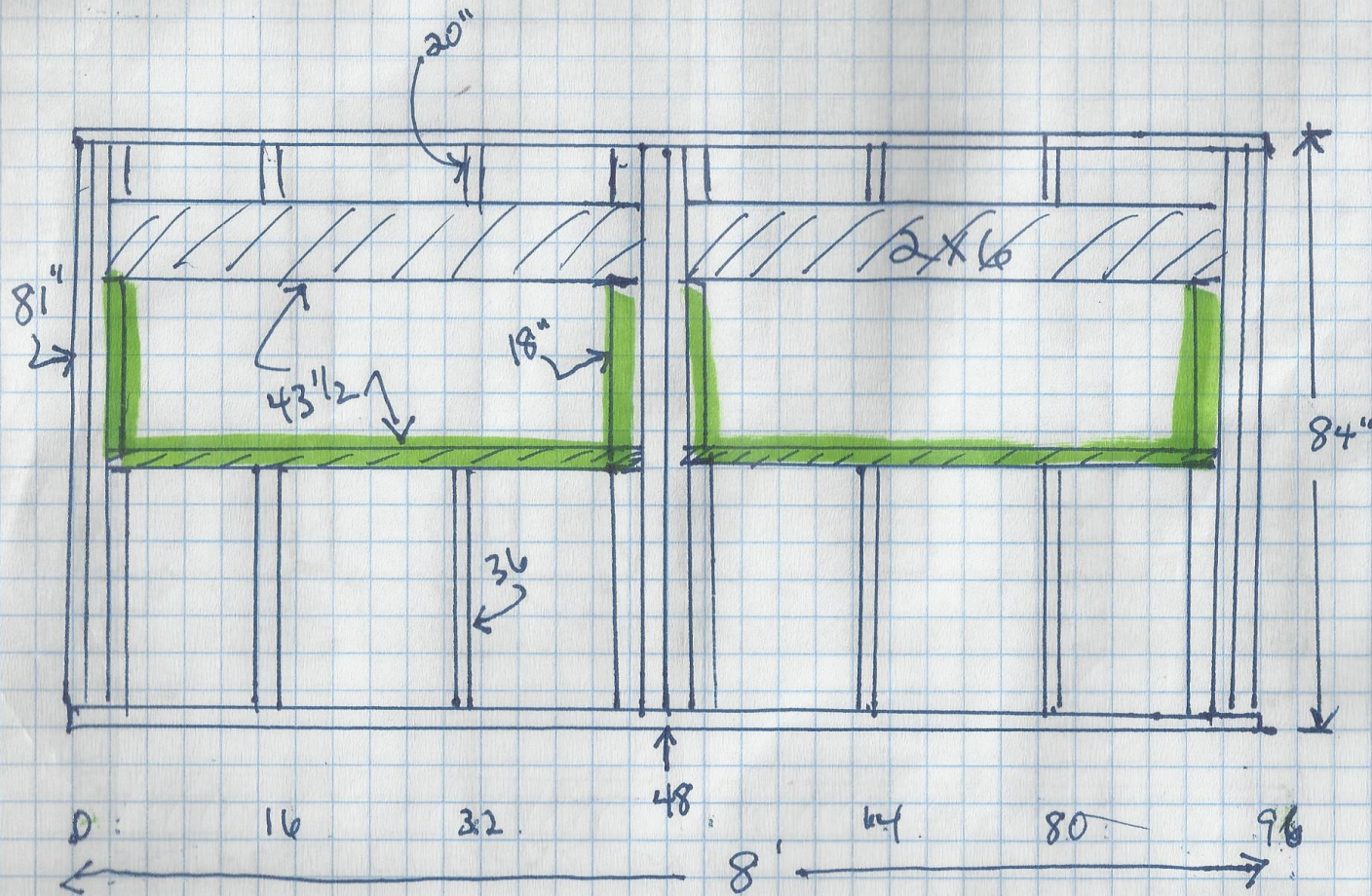

BACK WALL

TOTAL HGT: 78"

STUDS - 75"

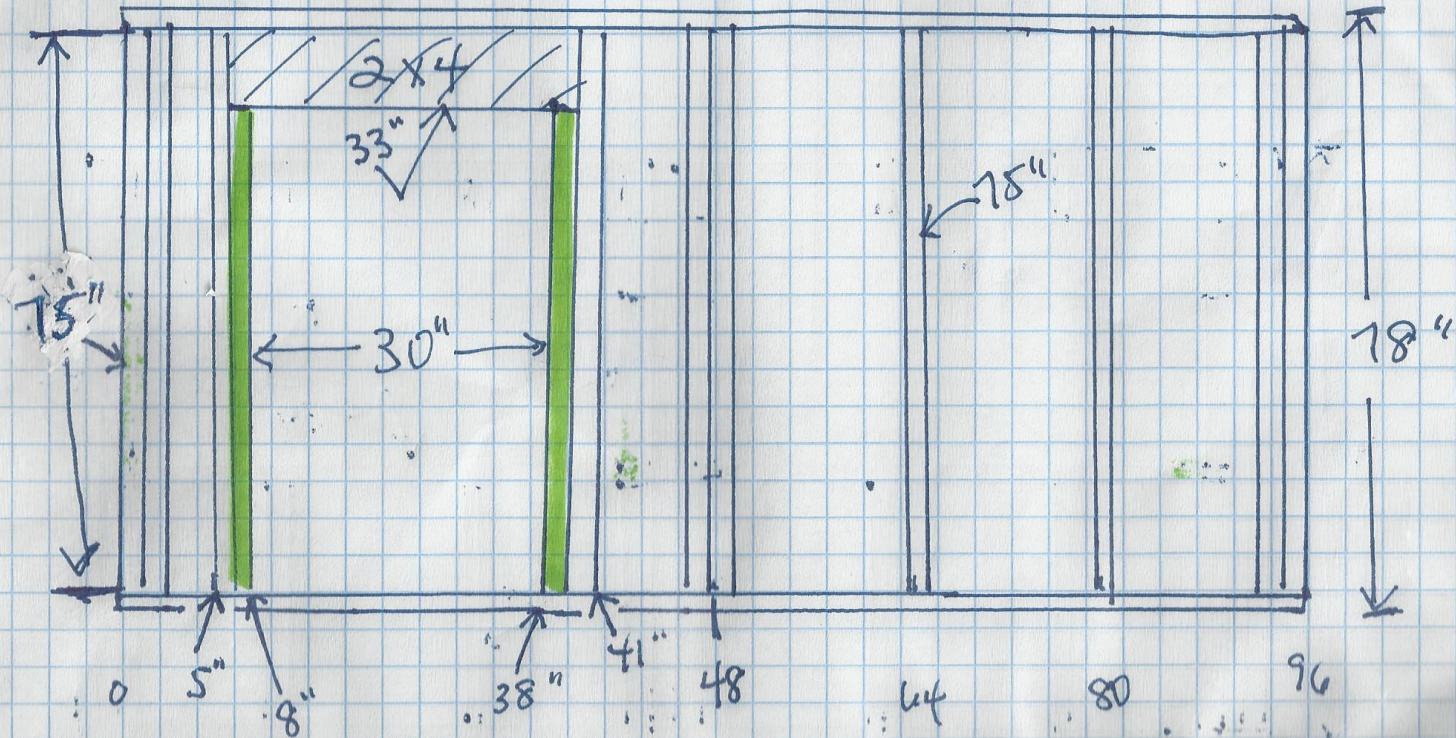



SIDE WALLS - #2

78" HIGH
65" WIDE

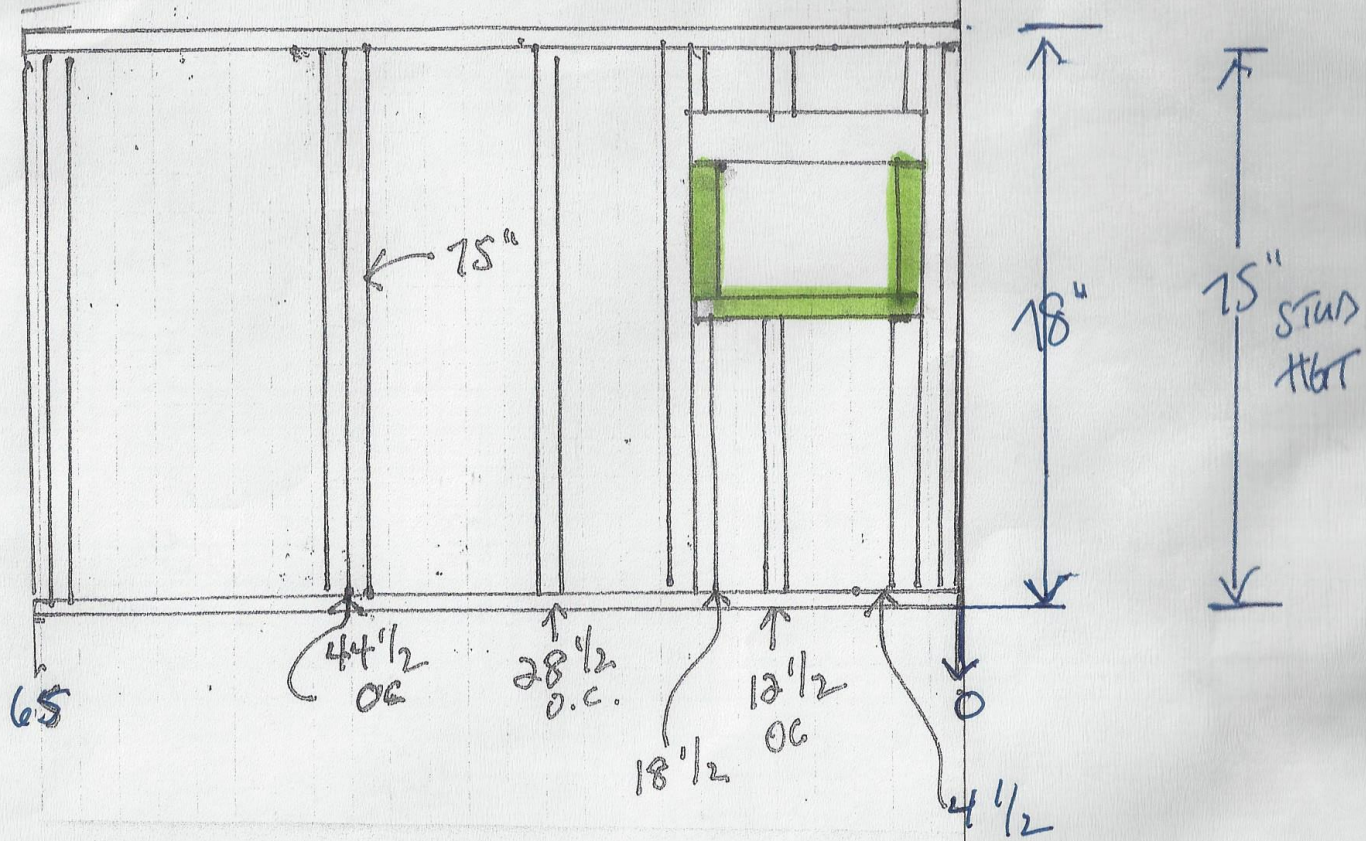

SIDE WALL 65" WIDE ($+3\frac{1}{2} + 3\frac{1}{2} = 72"$ WITH FRONT & BACK)

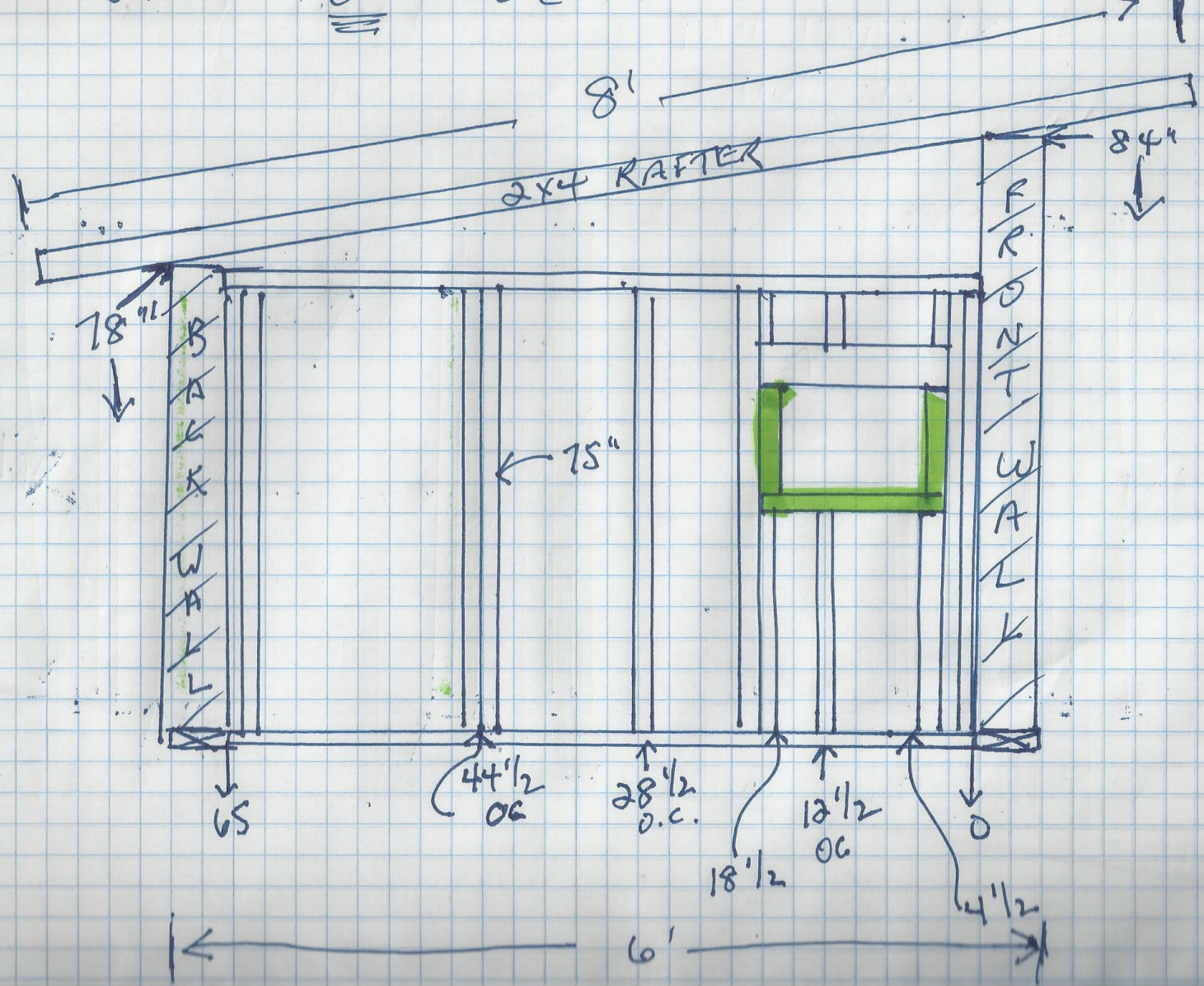

Rafters, Purlins, Roofing and Drip Edge

- Rafters placed every 2' on center from either side edge with hurricane or v-shape connectors.
- Cross purlins placed every 2' on center from either front/back edge secured with nails.
- Metal roof sheathing placed front to back with ~6" beyond front/back edge of purlins. Make sure sheaths overlap enough front to back to avoid water seepage. Use self tapping galvanized roof screws.
- Drip edge placed on either end of outer purlins/sheathing.
- Use bucket truck rental for roof placement?



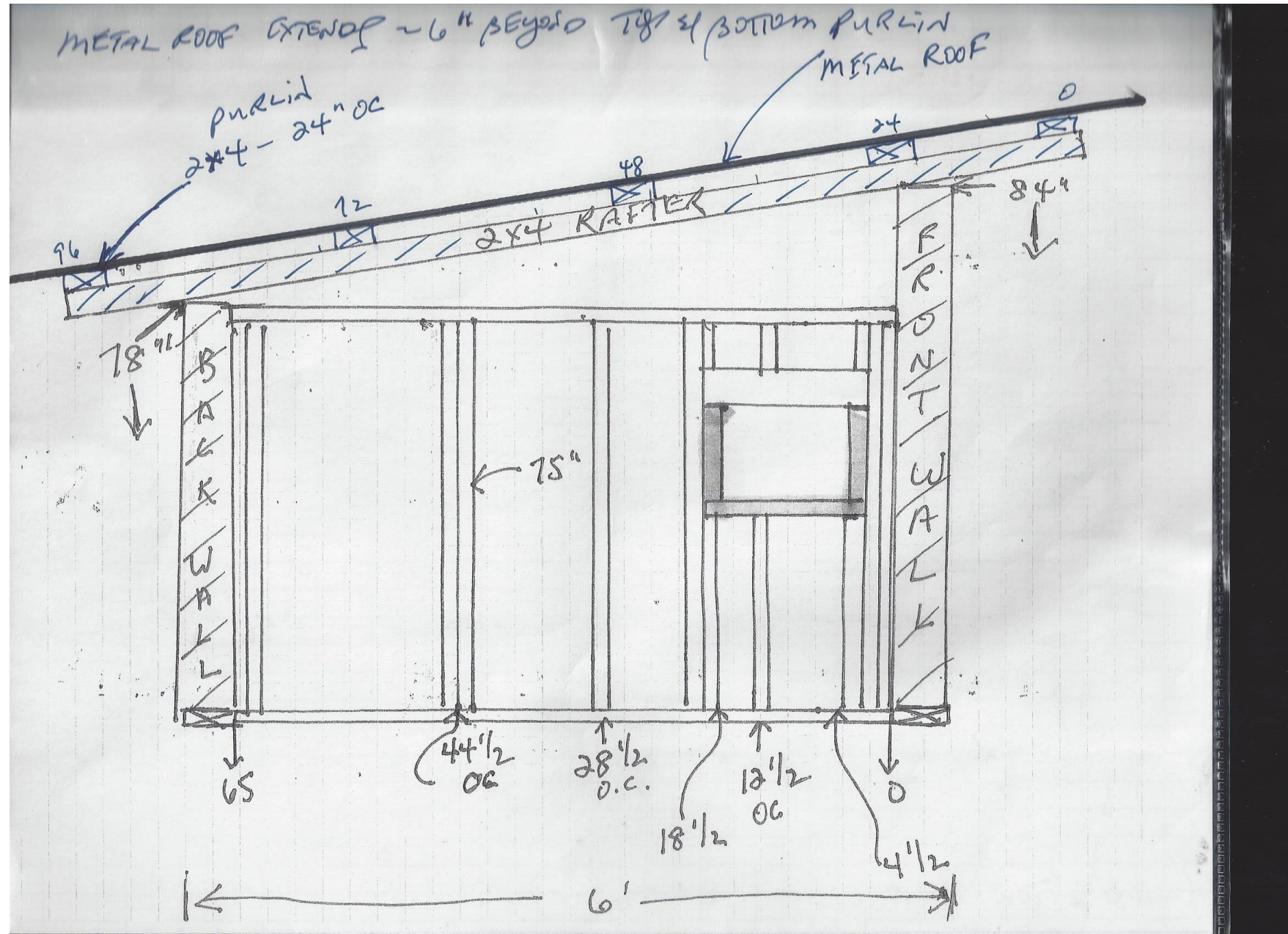

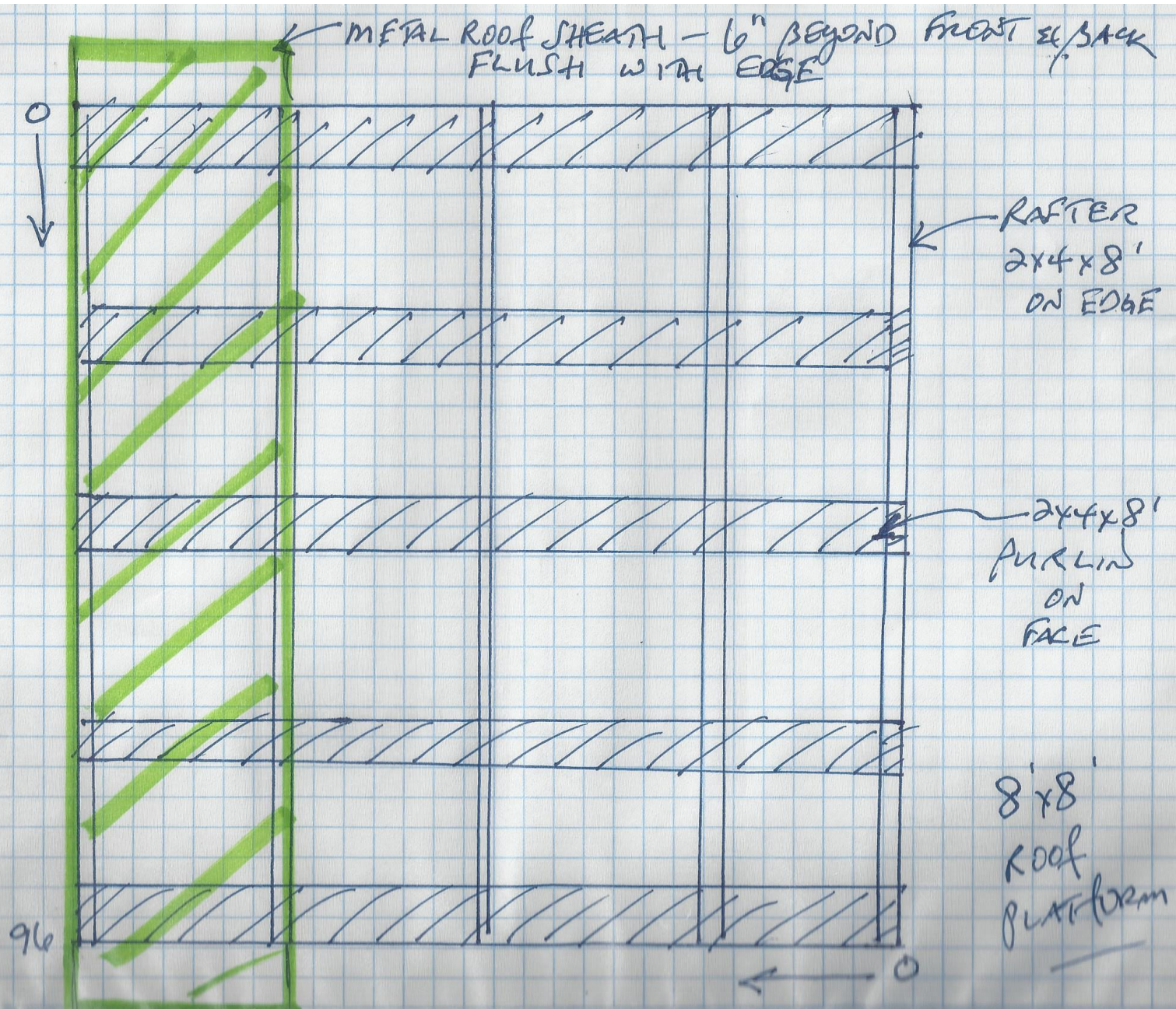

Siding Panels, Windows and Doors.

- Suggest painting siding prior to placement. Grey background with black/green large pattern stripes or camo of choice. Suggest painting interior upper half of back and side walls black.
- Suggest placing full 4x8' sheets on front and sides, and then cut out windows. You could place siding before walls erected or after – remember work at height needs special precautions.
- Full sheet placed on sides starting at front edge, thus allowing its other edge on double stud at 48". Will need to cut sheet for remaining 2 feet of coverage.
- At the four corners of siding you can place drip edge or wood trim to make siding edges waterproof (recommended).
- I suggest having a back door open into the blind; I place a latch that will hold a pad-lock. Door can be constructed of plywood and lumber leftovers and secured with a couple of conventional door hinges.



WALL
PANELS

4x8 SIDING PANEL
PLACE FULL PANEL STARTING AT FRONT EDGE
CUT OUT WINDOWS AFTER PLACEMENT

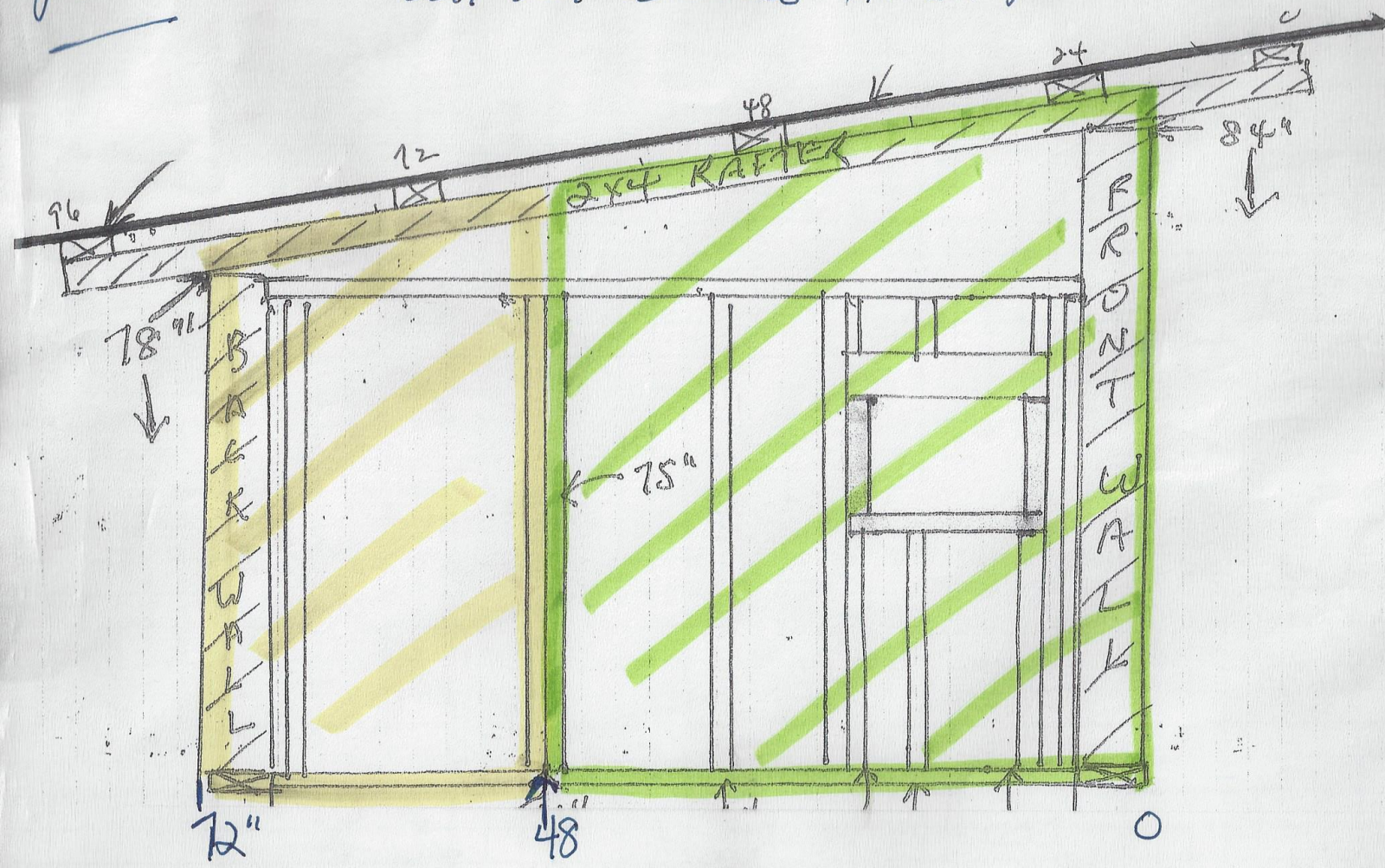

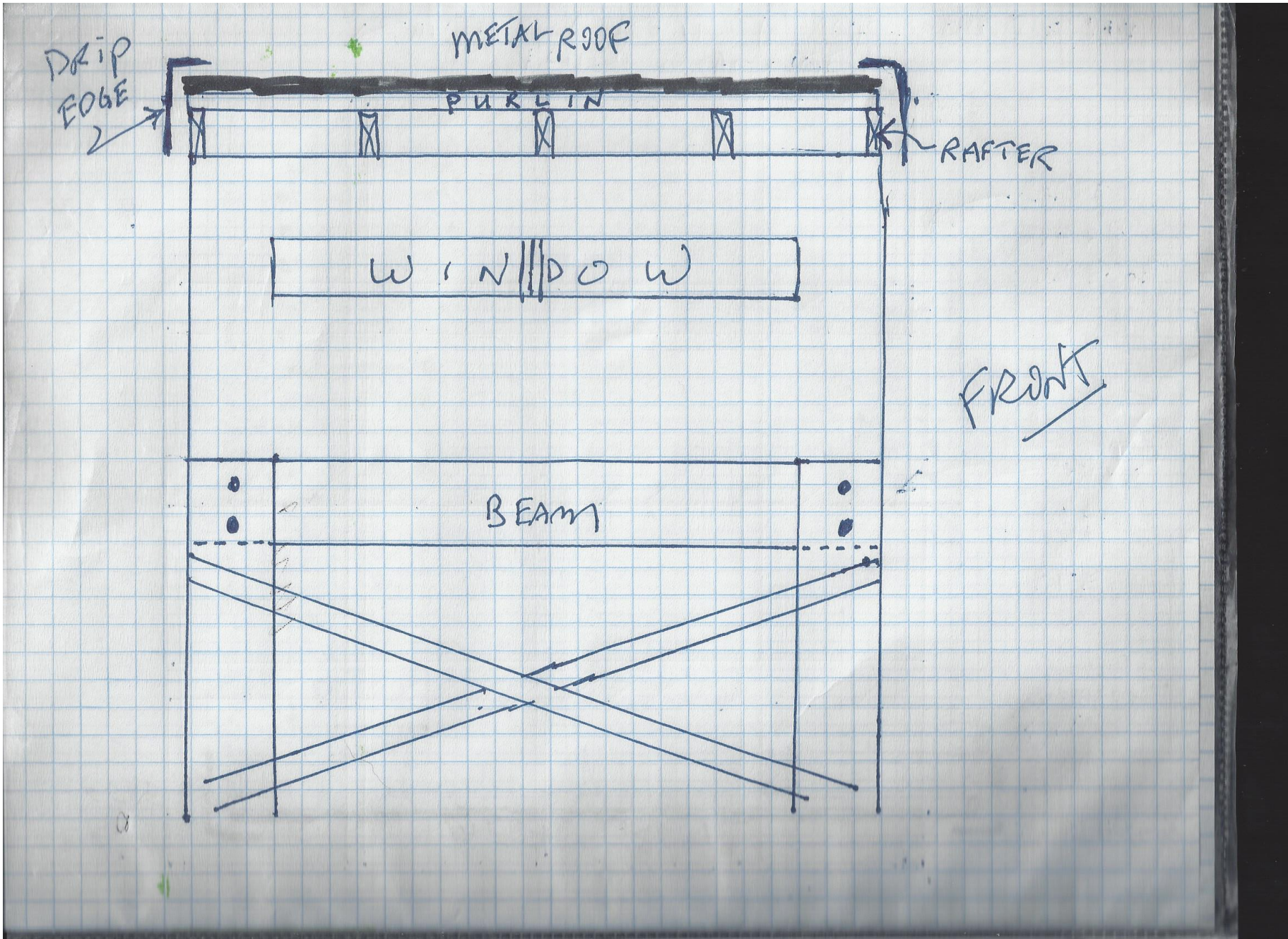

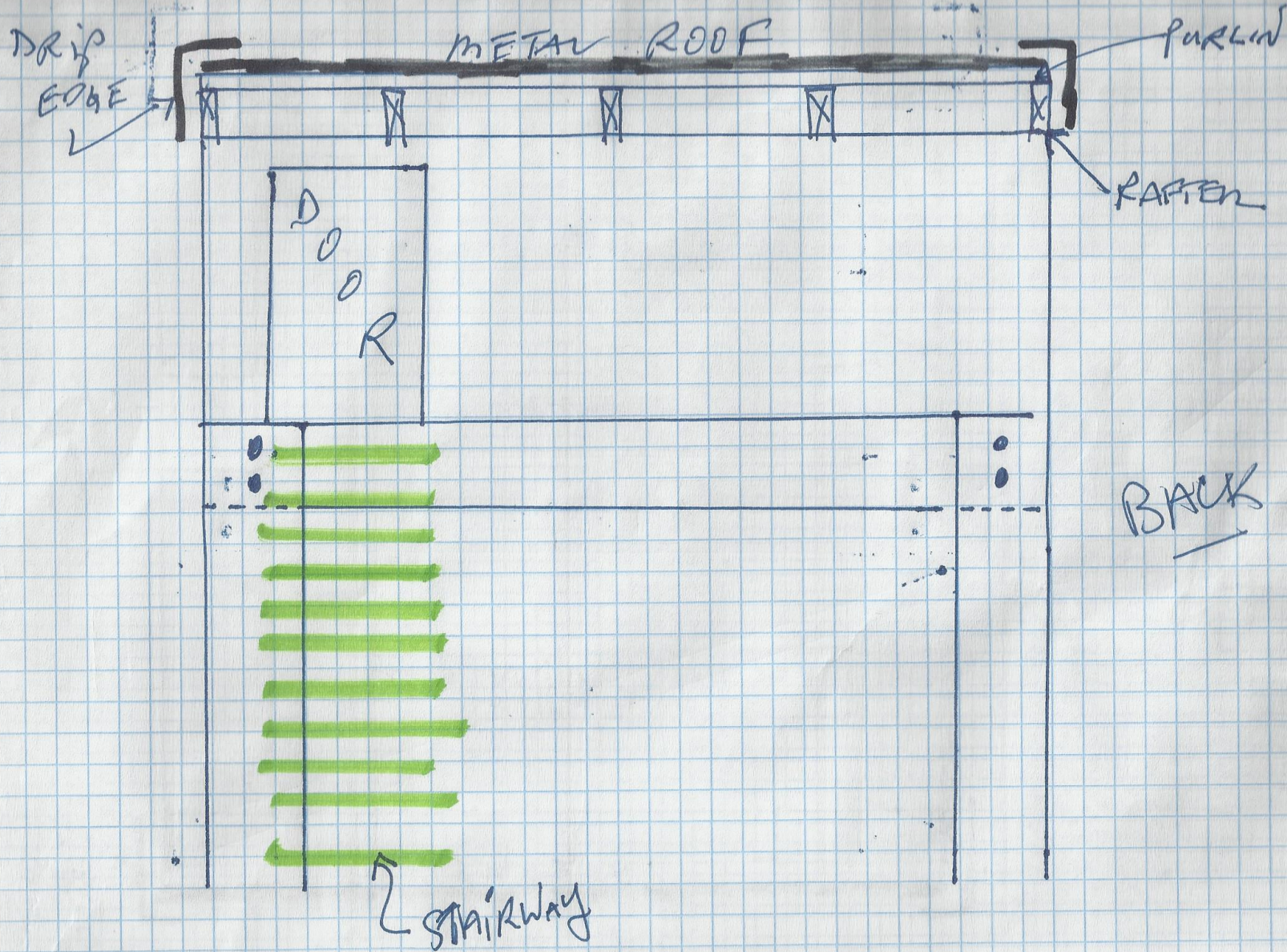

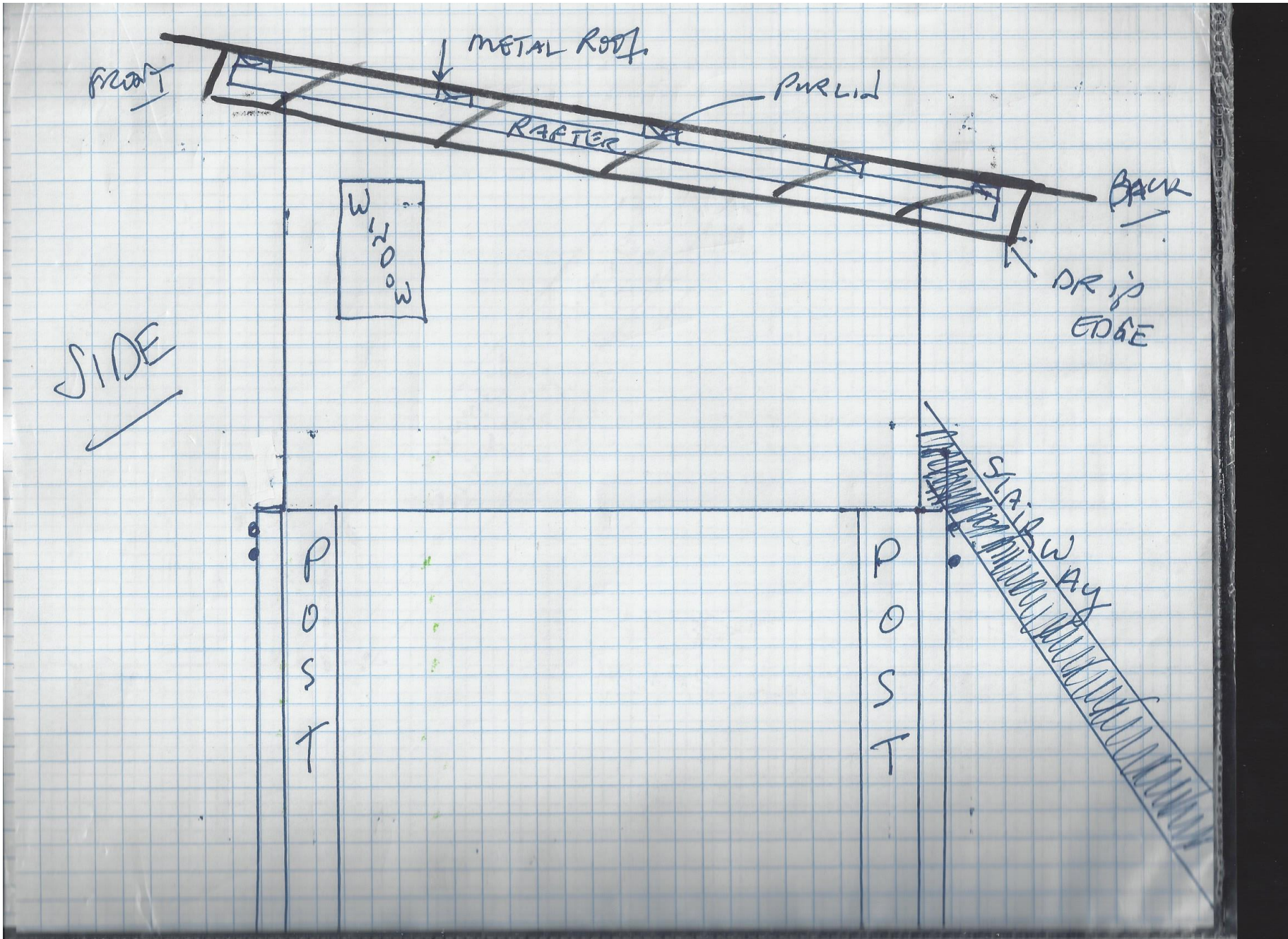

Ladder Stair

- REMEMBER: You ascend a ladder stair facing forward to the stand, and descend facing forward to the stand (thus stepping backwards while going down – just like you go up and down a ladder).
- A stairway railing is an important safety detail!
- Runner: 2x12x12' – this is for a 10' high platform.
- Treads 2x10x30" – your steps; this is the same width as the door.
- Cleats: 2x2x12" – this is what the treads lay on.
- A step height of 8", means 15 steps over 120" (10 feet of elevation).
 - $120"/8" = 15$ steps
- These 15 steps are placed at equal intervals over the span of the 12" runner – thus, every 9.6" on the runner.
 - $144"/15 = 9.6"$; thus your cleats and treads placed every 9.6" on runner.



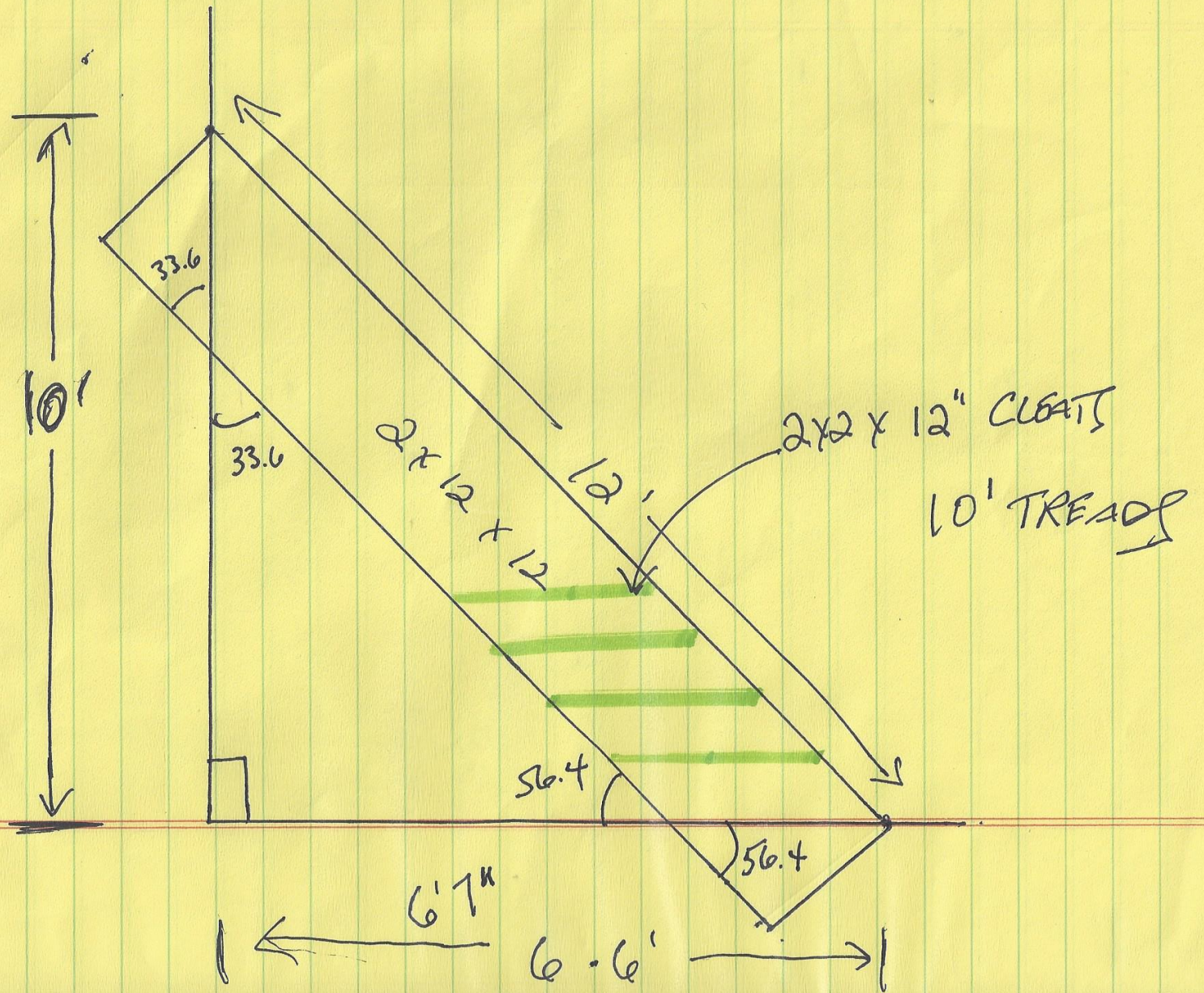

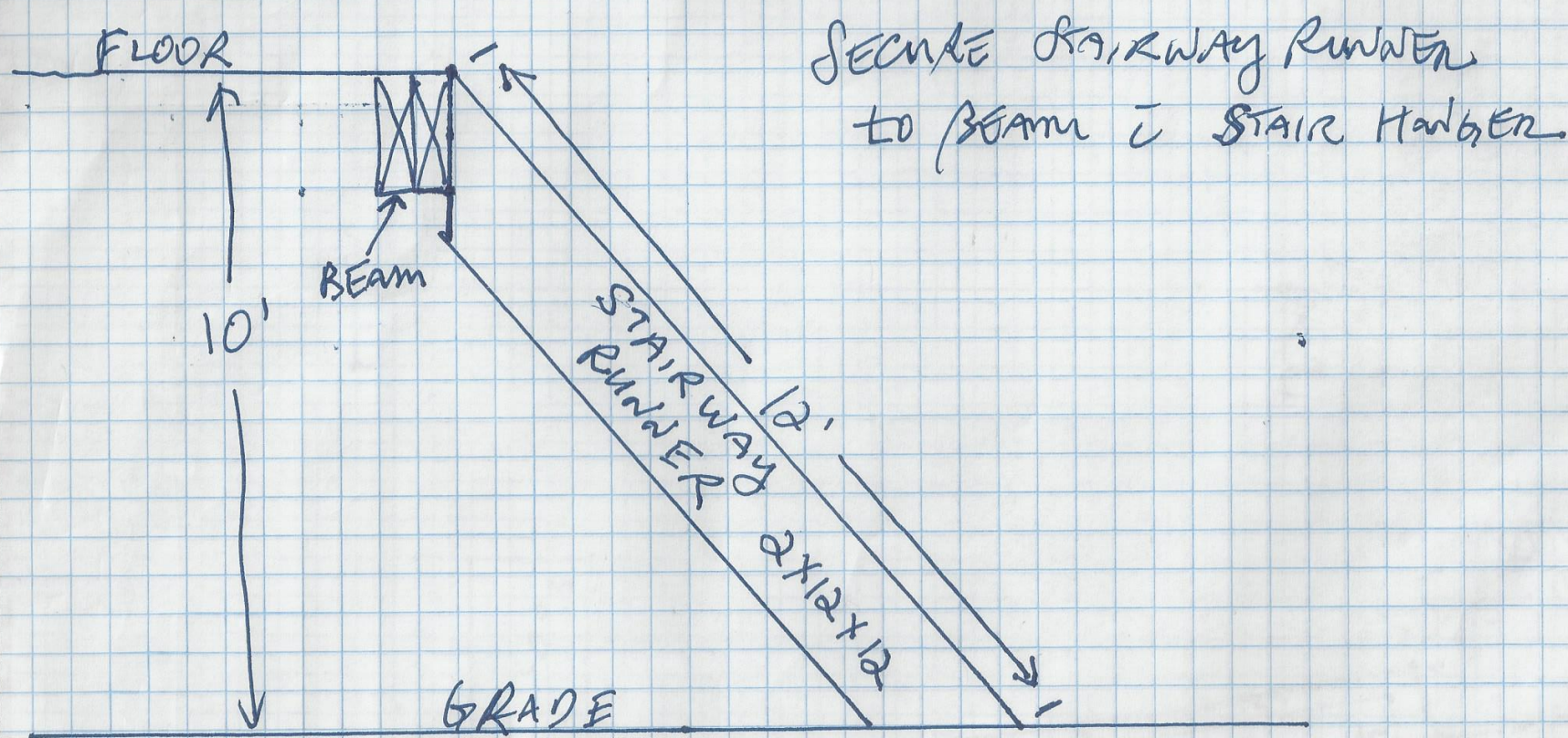

SECURE STAIRWAY RUNNER
TO BEAM & STAIR HANDER.



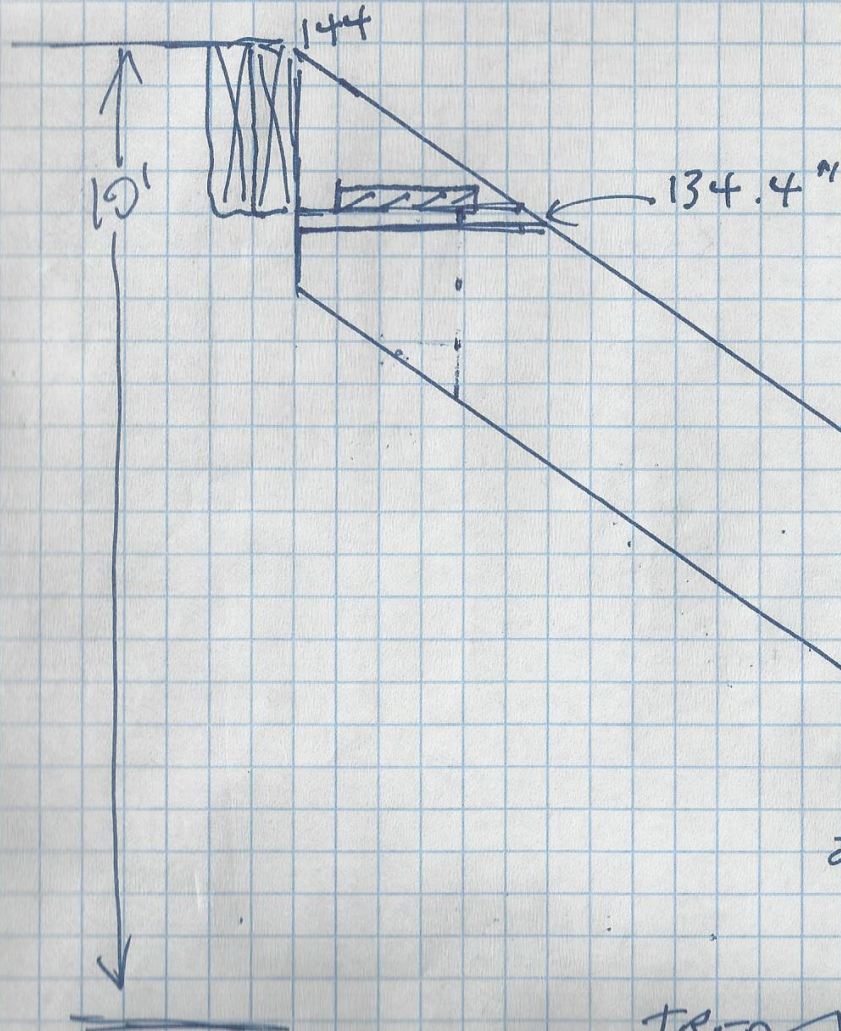

CLEATS 2x2x12"

TREADS OF 2x10x30"
 PLACED ON
 CLEATS &
 3" DECK SCREWS

3" DECK SCREWS FOR
 CLEATS & TREADS

CLEATS PLACED
 @ 9.6"

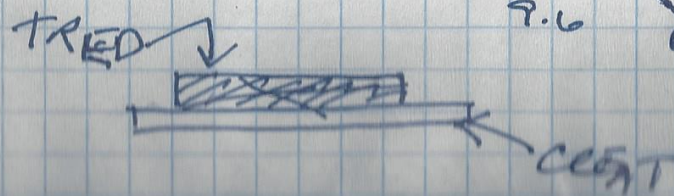

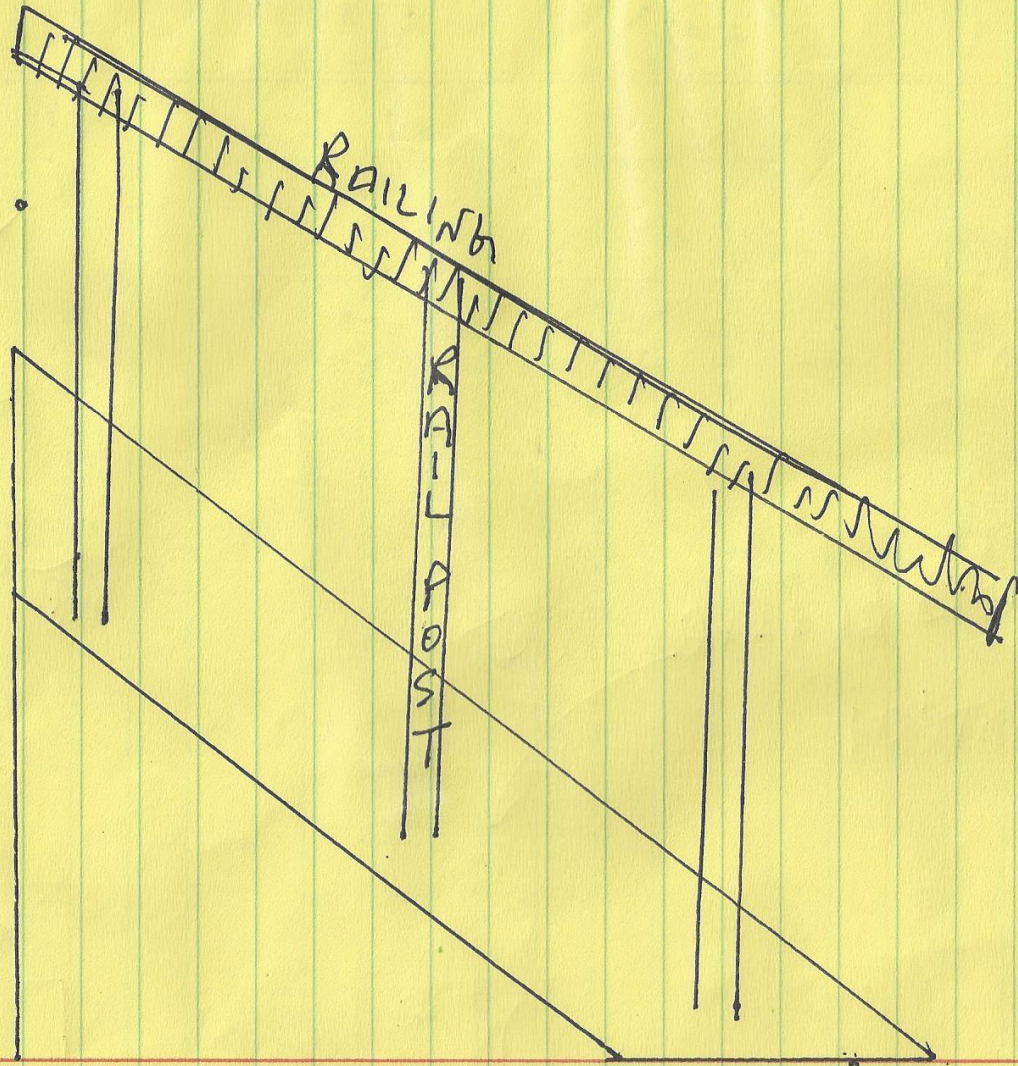

	A	B	C	D	E	F
1	Pine	#		unit price		Lowes March 2017
2	2x4x8	64	framing	\$3.07	\$196.48	Item # 6005 Model # 5089
3	2x6x8	2	header	\$4.84	\$9.68	Item # 30820 Model # 5089
4	3/4"x4x8	2	floor	\$25.78	\$51.56	Item # 12244 Model # 157946
5	Pressure Treated Pine					
6	4x6x12	4	posts	\$20.57	\$82.28	Item # 468957 Model # 46122
7	2x6x8	11	joists/posts	\$5.74	\$63.14	Item # 468934 Model # 2608P
8	2x8x8	4	beams	\$8.57	\$34.28	Item # 468938 Model # 2808P
9	2x4x8	4	windows	\$4.30	\$17.20	Item # 468930 Model # 2408P
10	2x4x10	10	bracing/stair rails	\$5.74	\$57.40	Item # 468931 Model # 2410P
11	2x12x12	2	stairs	\$23.77	\$47.54	Item # 468948 Model # 21212P
12	2x10x8	4	stairs	\$11.57	\$46.28	Item # 468942 Model # 21008P
13	2x2x8	3	stairs	\$3.27	\$9.81	Item # 468966 Model # 2208T
14	Siding/Roof					
15	siding panels 4x8	7		\$27.52	\$192.64	Item # 55897 Model # 27874
16	steel roofing panels 2.33 x 8'	6		\$10.25	\$61.50	Item # 12473 Model # 250OVALEC0800
17	drip edges 2.38 x 10'	2		\$4.38	\$8.76	Item # 366875 Model # G45TSRE
18	Miscellaneous					
19	ready mix concrete #60	12		\$3.39	\$40.68	Item # 293316 Model # NA
20	10D common smooth nails #5	1		\$9.87	\$9.87	Item # 69243 Model # 10C5
21	10D galvanized nails #5	1		\$12.78	\$12.78	Item # 69262 Model # 10HGC5
22	6D galvanized nails #5	1		\$12.78	\$12.78	Item # 69260 Model # 6HGC5
23	galv ext roofing screws self tap: 100 ct	1		\$12.00	\$12.00	Item # 579015 Model # 6738381000
24	deck screws #5 phillips	1		\$24.57	\$24.57	Item # 9470 Model # PTN3S5
25	1/2"x6" hex bolts	8		\$3.43	\$27.44	Item # 756044 Model # 260733
26	1/2" coated nut	8		\$0.49	\$3.92	Item # 756033 Model # 260704
27	1/2" coated washer	16		\$0.36	\$5.76	Item # 756041 Model # 260724
28	joist hanger 6-8"	10		\$0.96	\$9.60	Item # 116241 Model # JUS26-TZ
29	inverted flange joist hanger 6-8"	4		\$1.78	\$7.12	Item # 137755 Model # JL261F-TZ
30	zinc rafter tie v-shape	6		\$0.84	\$5.04	Item # 2741 Model # RT15-TZ
31	zinc hurricane tie	4		\$0.58	\$2.32	Item # 21993 Model # RT7A-TZ
32	post base	4		\$7.75	\$31.00	Item # 204690 Model # EBG44-TZ
33	stairway zinc stringer hanger	2		\$1.58	\$3.16	Item # 409136 Model # CSH-TZ



Comparative Pricing:

- 2017 materials cost ~ \$1,100 as diagrammed
 - 6'x8' blind @ 10' elevation – significantly larger than most commercial types.
 - Multiple Hunters, Cameraman, Youth Hunters, Shooting Rest, Seniors.
- 4'x6' box blind with 10' tower ~ \$2,340 Cabela's (Boss Buck Comfort Zone 4X6 Tower Blind)



- First prototype blind dates to 2008, with many design changes and improvements since then.
- This blind was actually 10'x6' – a virtual living room that in fact was felt to be too big!



